



RETAIL ± 375 – 1,400 RSF AVAILABLE FOR LEASE

PROPERTY FEATURES

Address: 6816 & 6820 Pacific Blvd., Huntington Park

- Prime location in Downtown area
- Major retail thoroughfare
- Excellent street frontage & visibility
- High density population
- Heavy day time and weekend traffic
- Heavy foot traffic
- Signage opportunities
- Strong retail demand
- Flexible lease terms
- Competitive lease rates
- Ample & free parking without time limit

DEMOGRAPHICS	1 MILE	2 MILE	3 MILE
Population	65,137	205,464	445,890
Average Income	\$51,034	\$51,152	\$50,323



CHANTEL AGUILAR
DIRECT: (562) 447-0665
 chantel@ashwillassociates.com
 chantelaguilar.com

CORP DRE #01291393/Lic. #01972085

Chantel Aguilar
 COMMERCIAL REAL ESTATE

Ashwill Associates
 COMMERCIAL REAL ESTATE

FLOOR PLANS - SECOND FLOOR

6816 & 6820 Pacific Blvd., Huntington Park

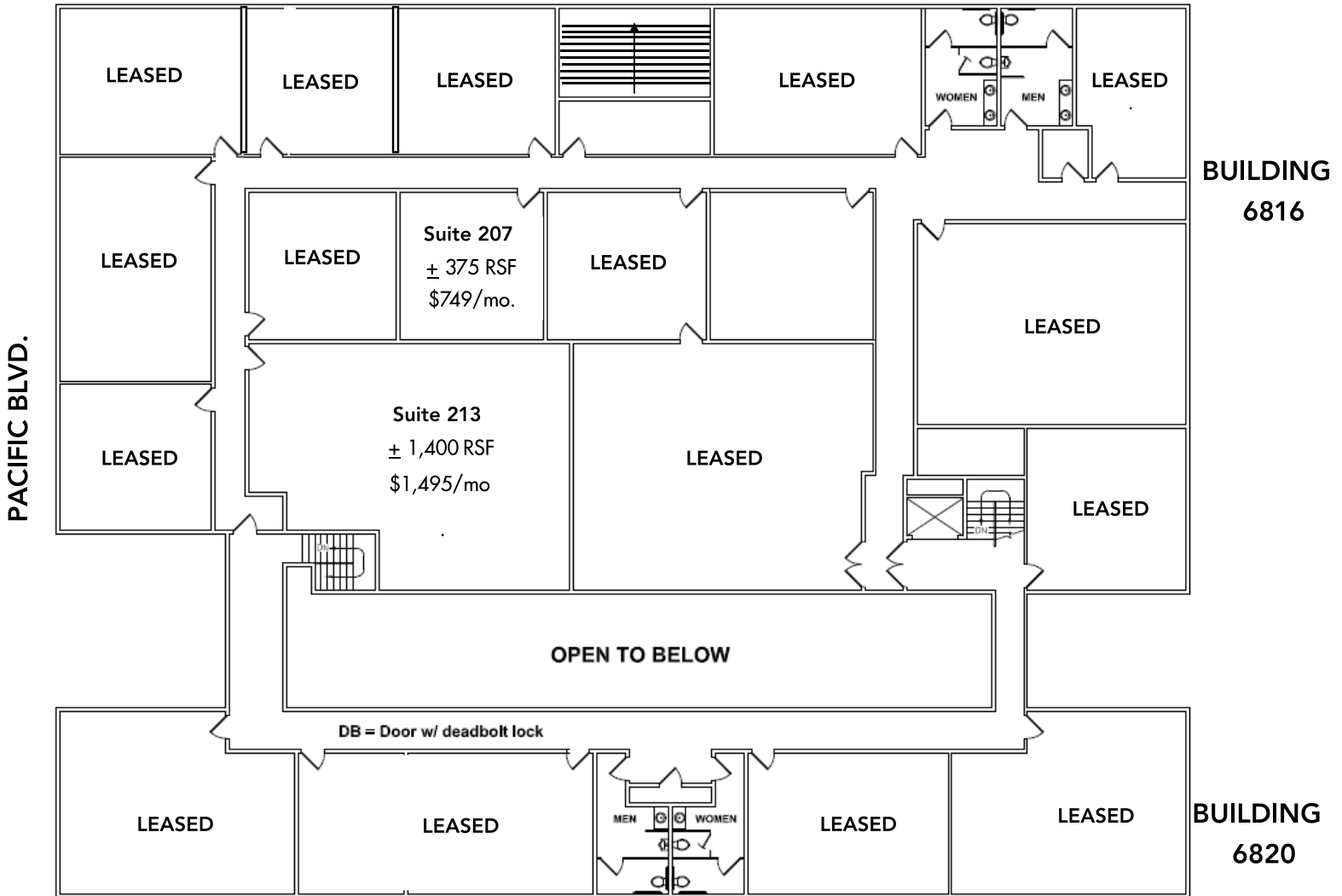

Price per month plus utilities

*floor plan not to scale



CHANTEL AGUILAR

DIRECT: (562) 447-0665

chantel@ashwillassociates.com

chantelaguilar.com

CORP DRE #01291393/Lic. #01972085

Chantel Aguilar
COMMERCIAL REAL ESTATE

**Ashwill
Associates**
COMMERCIAL REAL ESTATE

TRAFFIC COUNT

6816 & 6820 Pacific Blvd., Huntington Park



CHANTEL AGUILAR

DIRECT: (562) 447-0665

chantel@ashwillassociates.com

chantelaguilar.com

CORP DRE #01291393/Lic. #01972085

Chantel Aguilar
COMMERCIAL REAL ESTATE

**Ashwill
Associates**
COMMERCIAL REAL ESTATE